

# EVESHAM CORPORATE CENTER

4A & 4B Eves Drive, Cherry Hill, NJ



## PREMIERSUITES AVAILABLE FOR LEASE

### TWO BUILDINGS

IMMEDIATE OCCUPANCY

### PROPERTY FEATURES

- Lease Price: Call for information
- Under new ownership and management
- Capital improvements throughout
- 4A Eves:
  - Suite 106: 1,832 SF
- 4B Eves:
  - Suite 400: 2,000 SF
    - Warehouse with 1 drive-in
- Monument tenant directory and suite signage available
- Ample parking
- Available for immediate occupancy
- Two miles from NJ Turnpike, I-295 and Route 70



# 4A EVES DRIVE FLOOR PLAN

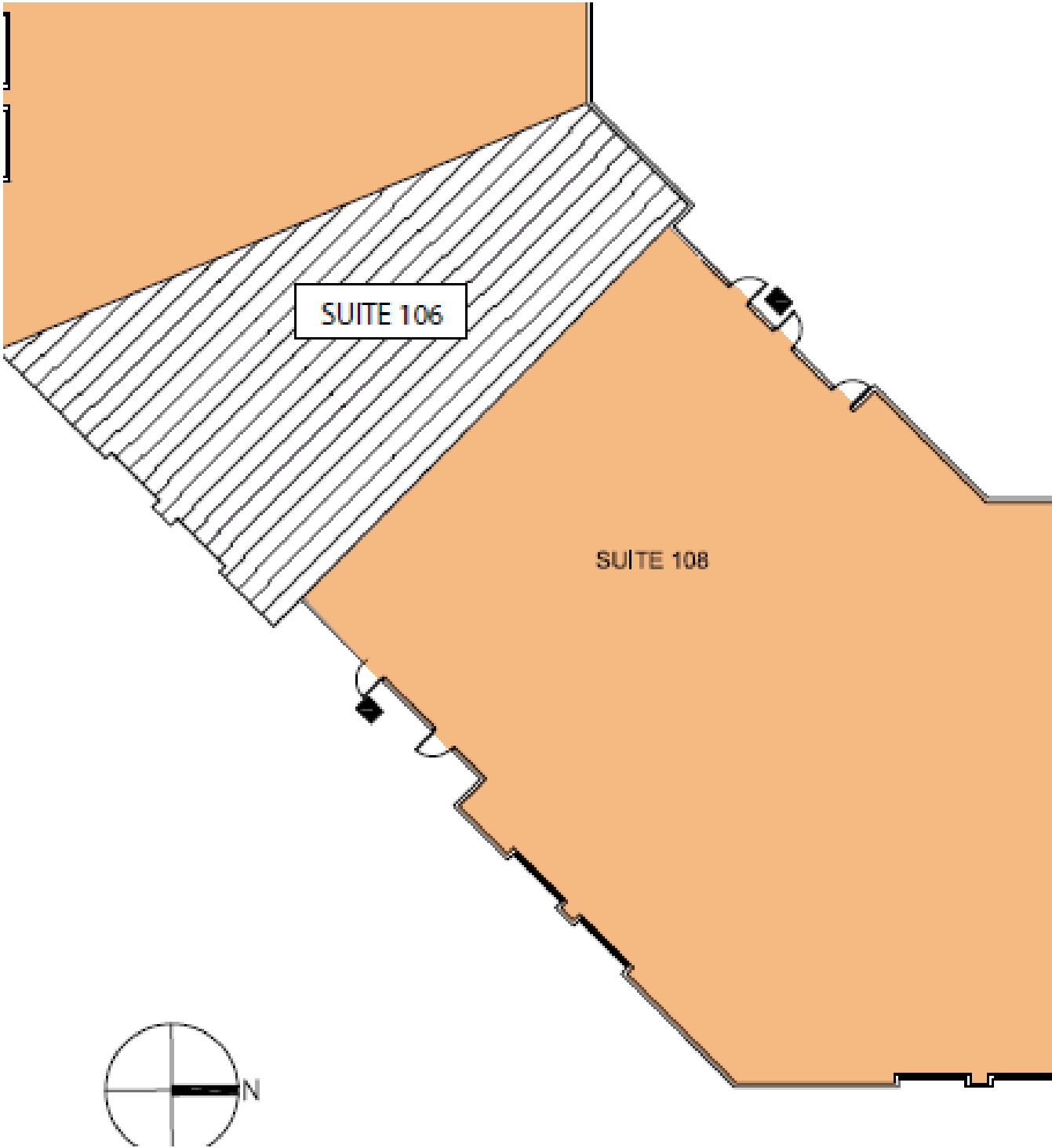

The foregoing information was furnished to us by sources which we deem to be reliable, but no warranty or representation is made as to the accuracy thereof. Subject to correction of errors, omissions, change of price, prior sale or withdrawal from market without notice.

# 4B EVES DRIVE FLOOR PLAN



The foregoing information was furnished to us by sources which we deem to be reliable, but no warranty or representation is made as to the accuracy thereof. Subject to correction of errors, omissions, change of price, prior sale or withdrawal from market without notice.



[www.WolfCRE.com](http://www.WolfCRE.com)

**Bethany Brown**  
Executive Vice President  
267.226.6602  
[bethany.brown@wolfcre.com](mailto:bethany.brown@wolfcre.com)



# LOCAL MAP

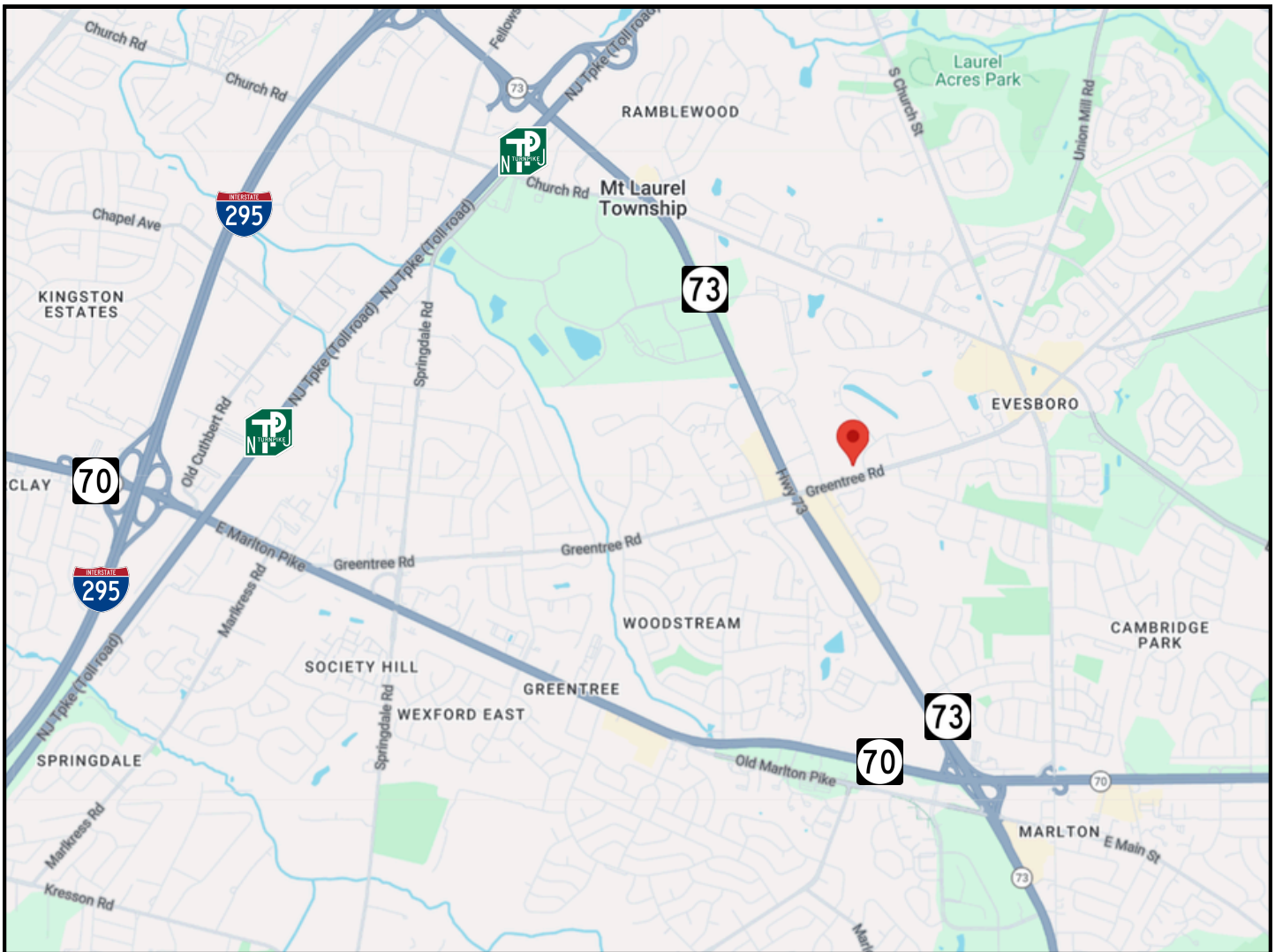

## DISTANCES

- ROUTE 73:** .5 miles
- ROUTE 70:** 1 mile
- I-295:** 3.5 miles
- NJ TURNPIKE:** 5.5 miles

## RETAILERS & RESTAURANTS WITHIN 5 MILES

- The Promenade at Sagemore
- Marlton Crossing
- Best Buy
- Walmart
- Trader Joe's
- Texas Roadhouse
- Cafe Lucky Bones
- TD Bank

The foregoing information was furnished to us by sources which we deem to be reliable, but no warranty or representation is made as to the accuracy thereof. Subject to correction of errors, omissions, change of price, prior sale or withdrawal from market without notice.



[www.WolfCRE.com](http://www.WolfCRE.com)

**Bethany Brown**  
Executive Vice President  
267.226.6602  
[bethany.brown@wolfcre.com](mailto:bethany.brown@wolfcre.com)

