



1200 LOCUST STREET | PHILADELPHIA, PA 19107

PROPERTY DESCRIPTION

- Location** 1200 Locust Street
Philadelphia, PA 19107
- Size / SF Available** +/- 7,045 SF
- Sale Price** Call for information
- Property / Area Description**
- Fully built-out Medical Office Building located in heart of Center City
 - 4 Stories
 - Medical Building Consists of two entrances, one operating room, multiple private offices, two reception areas, and multiple exam rooms
 - Income producing property with tenant in place
 - Existing elevator shaft
 - 1 block from 12/13th & Locust Street PATCO Station
 - Zoning: CMX-1

Contact Us

Sean Kelly
Senior Advisor
856.630.5806
sean.kelly@wolfcre.com

Phil Costa
Senior Advisor
609.680.4942
phil.costa@wolfcre.com



follow us:    

The foregoing information was furnished to us by sources which we deem to be reliable, but no warranty or representation is made as to the accuracy thereof. Subject to correction of errors, omissions, change of price, prior sale or withdrawal from market without notice.

DEMOGRAPHICS MAP

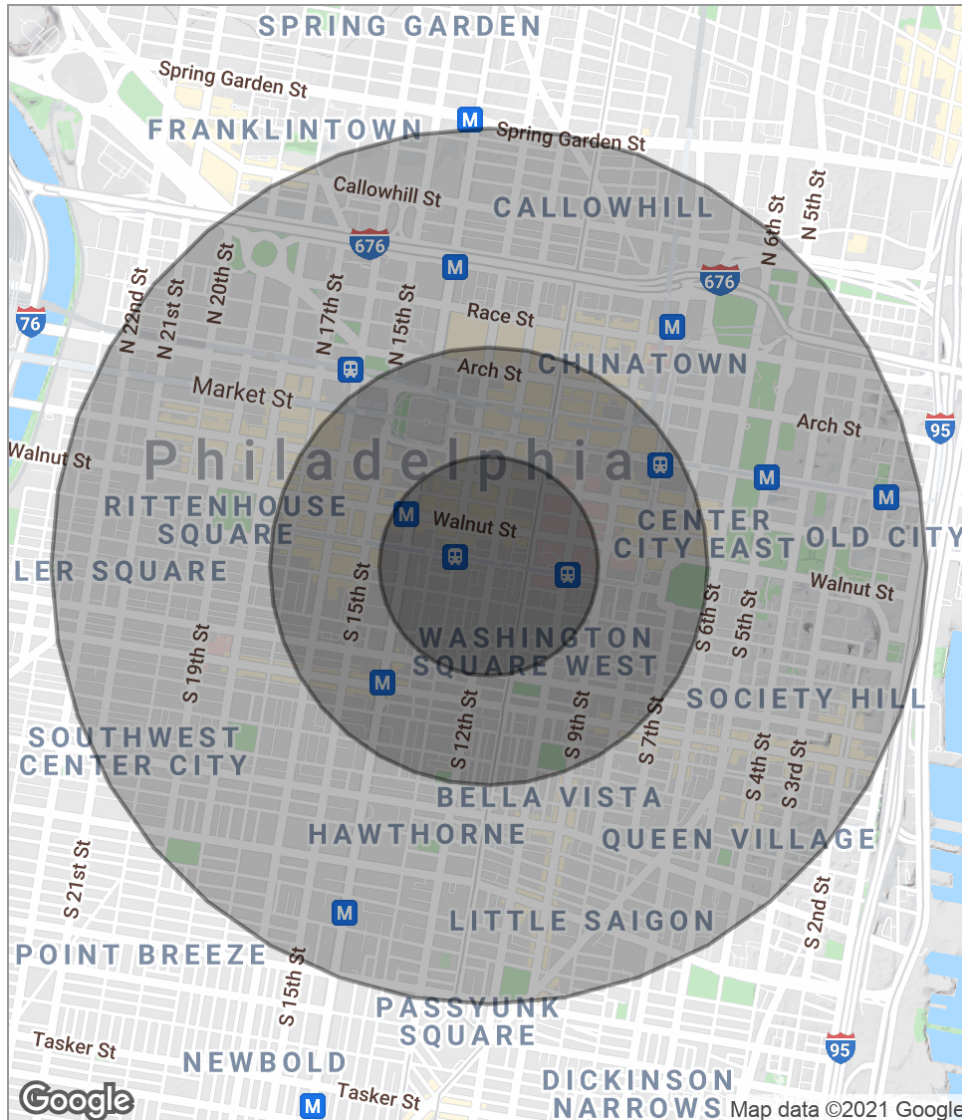

POPULATION	0.25 MILES	0.5 MILES	1 MILE
Total population	7,145	23,438	76,969
Median age	31.1	33.2	35.4
Median age (male)	34.5	34.6	36.4
Median age (Female)	28.9	31.6	34.5
HOUSEHOLDS & INCOME	0.25 MILES	0.5 MILES	1 MILE
Total households	4,483	14,029	43,148
# of persons per HH	1.6	1.7	1.8
Average HH income	\$63,577	\$75,414	\$83,294
Average house value		\$389,524	\$416,421

** Demographic data derived from 2010 US Census*

The foregoing information was furnished to us by sources which we deem to be reliable, but no warranty or representation is made as to the accuracy thereof. Subject to correction of errors, omissions, change of price, prior sale or withdrawal from market without notice.

CMX-1 ZONING | NEIGHBORHOOD COMMERCIAL MIXED-USE

CMX-1

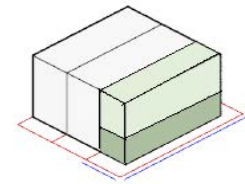

All dimensions based on residential adjacent zoning districts.

Y = Yes permitted as of right | S = Special exception approval required | N = Not allowed (expressly prohibited)
Uses not listed in this table are prohibited.

CMX-1

Residential Use Category	
Household Living (as noted below)	
Single-family	[1]
Two-family	[1]
Multi-family	[1] [2]
Group Living (except as noted below)	N
Personal Care Home	N
Single-Room Residence	N
Parks and Open Spaces Use Category	
Passive Recreation	Y
Active Recreation	S
Public, Civic, and Institutional Use Category	
Day Care (as noted below)	
Family Day Care	Y
Group Day Care	Y
Day Care Center	S
Educational Facilities	N
Fraternal Organization	N
Hospital	N
Libraries and Cultural Exhibits	Y
Religious Assembly	Y
Safety Services	Y
Transit Station	Y
Utilities and Services, Basic	S
Wireless Service Facility (as noted below)	
Freestanding Tower	S
Building or Tower-Mounted Antenna	Y
Office Use Category	
Business and Professional	Y[5]
Medical, Dental, Health Practitioner (as noted below)	
Sole Practitioner	Y[5]
Group Practitioner	S[5]
Government	Y[5]
Retail Sales Use Category	
Building Supplies and Equipment	Y[5]
Consumer Goods (except as noted below)	Y[5]
Drug Paraphernalia Sales	N
Gun Shop	N
Food, Beverages, and Groceries	Y[5]
Pets and Pet Supplies	Y[5]
Sundries, Pharmaceuticals, and Convenience Sales	Y[5]
Wearing Apparel and Accessories	Y[5]
Commercial Services Use Category	
Animal Services (except as noted below)	Y[5]
Boarding and Other Services	N
Assembly and Entertainment (except as noted below)	N
Amusement Arcade	N
Casino	N

Max. Occupied Area	CMX-1 Occupied Area, Building Dimensions, and Height are based on the requirements of adjacent residential zoning districts in order to match the neighborhood surroundings. [1]
Min. Front Yard Depth	
Min. Side Yard Width	
Min. Rear Yard Depth	
Max. Height	

Nightclubs and Private Clubs	N
Pool or Billiards Room	N
Building Services	N
Business Support	Y[5]
Eating and Drinking Establishments (as noted below)	
Prepared Food Shop	S[5]
Take-Out Restaurant	N
Sit Down Restaurant	N
Financial Services (except as noted below)	Y[5]
Personal Credit Establishment	N
Funeral and Mortuary Services	S[5]
Maintenance & Repair of Consumer Goods (except as noted below)	Y[5]
On-Premise Dry Cleaning	Y[5]
Marina	N
Parking, Non-Accessory (as noted below)	
Surface Parking	N
Structured Parking	N
Personal Services (except as noted below)	Y[5]
Body Art Service	N
Fortune Telling Service	N
Radio, Television, and Recording Services	N
Visitor Accommodations	N
Commissaries and Catering Services	N
Commercial Vehicle Sales and Rental	N
Personal Vehicle Repair and Maintenance	N
Personal Vehicle Sales and Rental	N
Vehicle Fueling Station	N
Vehicle Equipment and Supplies Sales and Rental	N
Moving and Storage Facilities	N
Wholesale Sales and Distribution	N
Industrial Use Category	
Artist Studios and Artisan Industrial	N
Research and Development	N
Urban Agriculture Use Category	
Community Garden	Y
Market or Community-Supported Farm	Y

The foregoing information was furnished to us by sources which we deem to be reliable, but no warranty or representation is made as to the accuracy thereof. Subject to correction of errors, omissions, change of price, prior sale or withdrawal from market without notice.

ADDITIONAL PHOTOS



The foregoing information was furnished to us by sources which we deem to be reliable, but no warranty or representation is made as to the accuracy thereof. Subject to correction of errors, omissions, change of price, prior sale or withdrawal from market without notice.