

EVESHAM CORPORATE CENTER

2 Eves Drive, Marlton, NJ



PREMIER OFFICE SUITES AVAILABLE FOR LEASE

MULTIPLE SUITES AVAILABLE

Up to +/- 18,125 SF

**Suites can be combined*

PROPERTY FEATURES

- Lease Price: Call for information
- Ideal for professional office users
- New ownership and management
- Capital improvements throughout
- First Floor Vacancy:
 - Suite 103: 2,559 SF*
 - Suite 104: 1,320 SF*
 - Suite 105: 1,267 SF*
 - Suite 115: 1,391 SF
- Second Floor Vacancy:
 - Suite 200: 5,089 SF*
 - Suite 204: 6,499 SF*
- Monument tenant directory and suite signage available
- Ample parking
- Available for immediate occupancy
- Two miles from NJ Turnpike, I-295 and Route 70



FIRST FLOOR PLAN

ALL 3 SUITES CAN BE COMBINED FOR TOTAL OF 5,146 SF

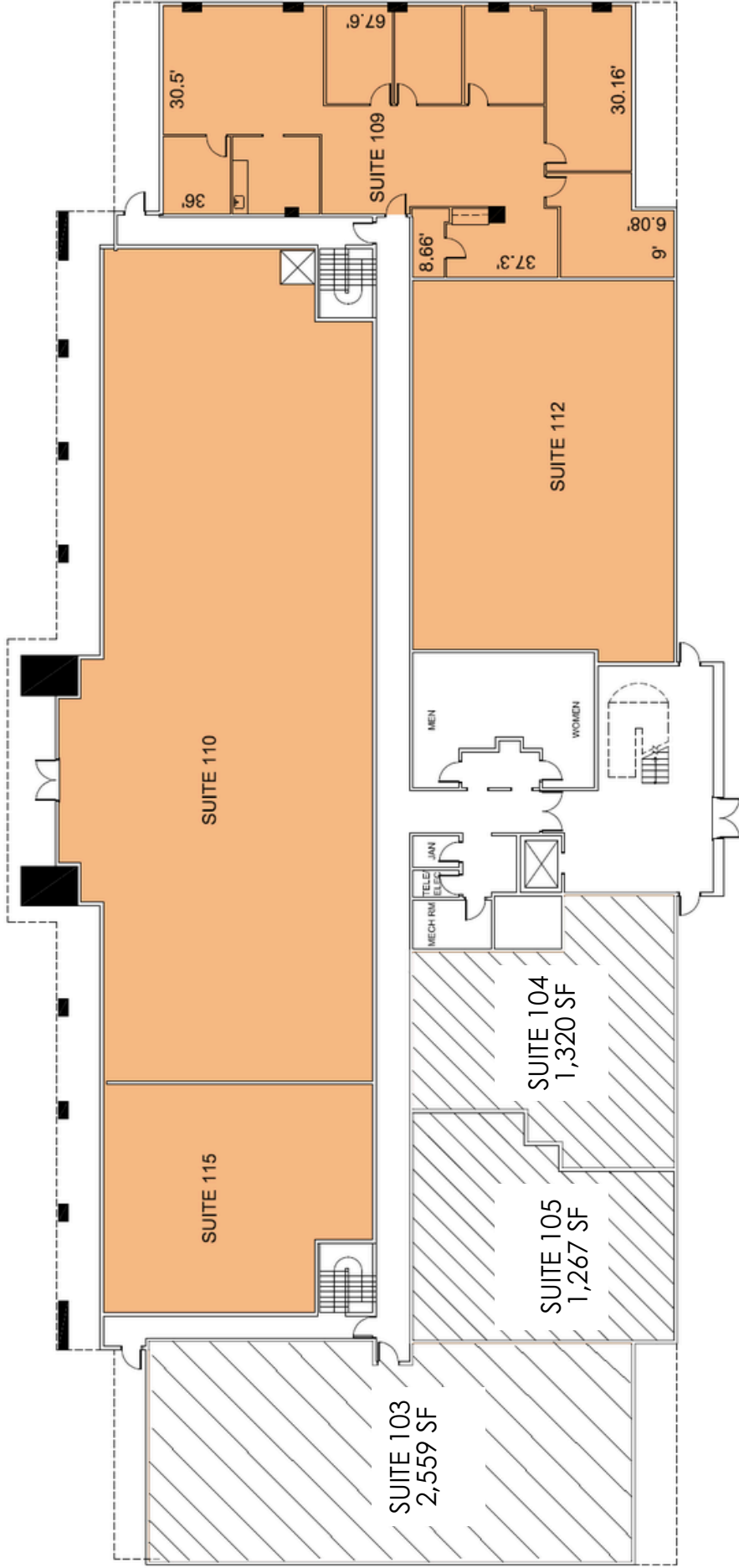

The foregoing information was furnished to us by sources which we deem to be reliable, but no warranty or representation is made as to the accuracy thereof. Subject to correction of errors, omissions, change of price, prior sale or withdrawal from market without notice.



www.WolfCRE.com

Bethany Brown
 Executive Vice President
 267.226.6602
bethany.brown@wolfcre.com



SECOND FLOOR PLAN

BOTH SUITES CAN BE COMBINED FOR TOTAL OF 11,588 SF

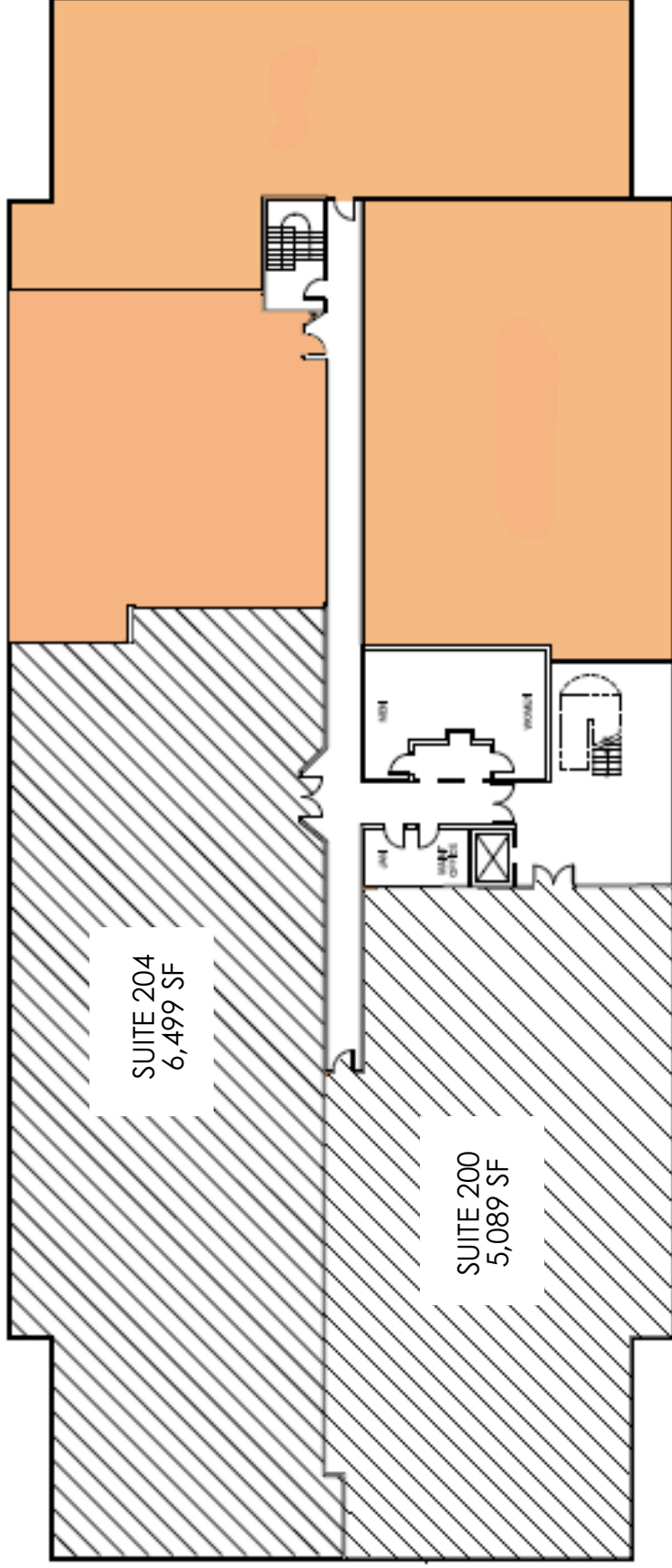

The foregoing information was furnished to us by sources which we deem to be reliable, but no warranty or representation is made as to the accuracy thereof. Subject to correction of errors, omissions, change of price, prior sale or withdrawal from market without notice.



www.WolfCRE.com

Bethany Brown
Executive Vice President
267.226.6602
bethany.brown@wolfcre.com



LOCAL MAP

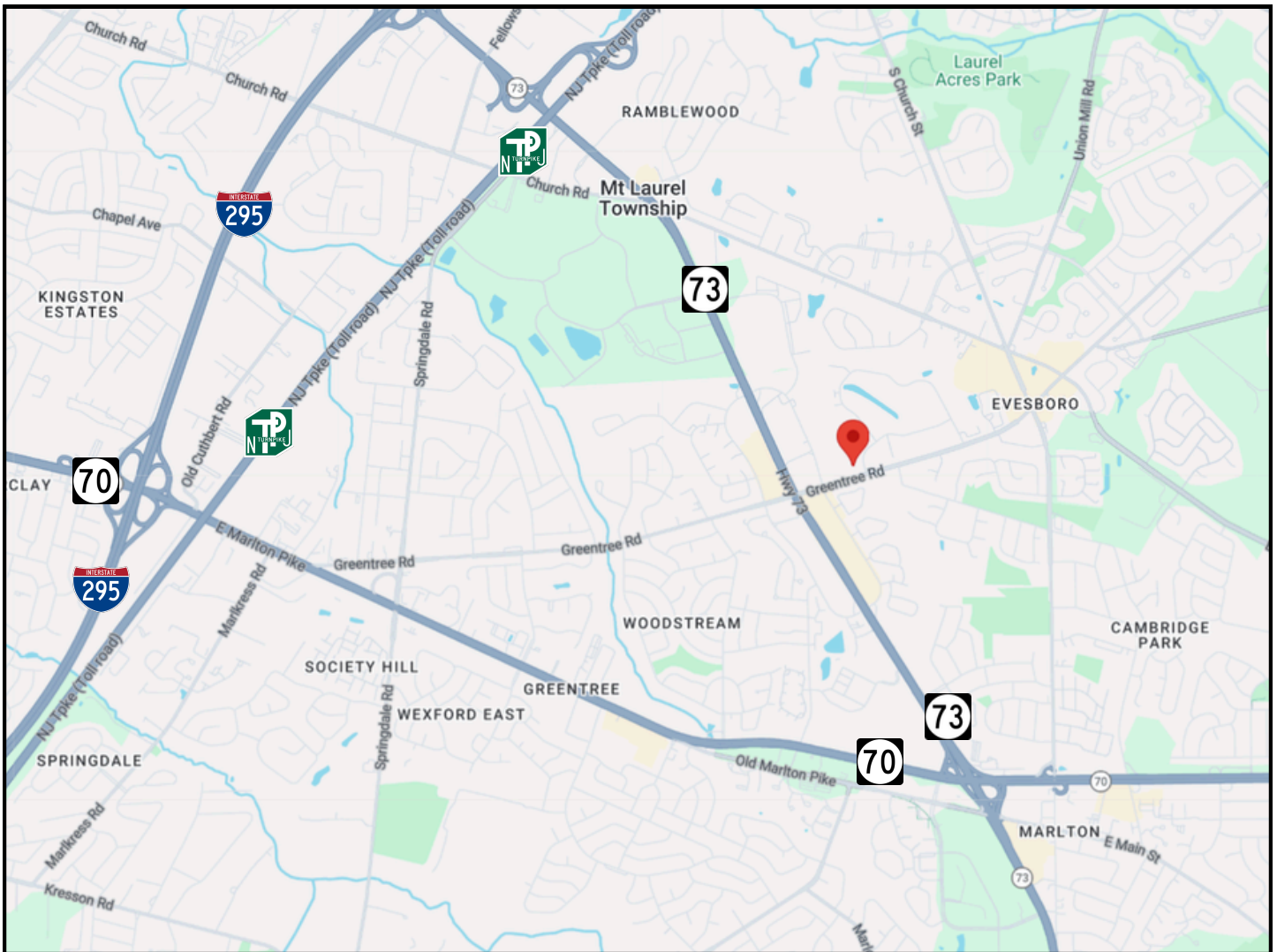

DISTANCES

- ROUTE 73:** .5 miles
- ROUTE 70:** 1 mile
- I-295:** 3.5 miles
- NJ TURNPIKE:** 5.5 miles

RETAILERS & RESTAURANTS WITHIN 5 MILES

- The Promenade at Sagemore
- Marlton Crossing
- Best Buy
- Walmart
- Trader Joe's
- Texas Roadhouse
- Cafe Lucky Bones
- TD Bank

The foregoing information was furnished to us by sources which we deem to be reliable, but no warranty or representation is made as to the accuracy thereof. Subject to correction of errors, omissions, change of price, prior sale or withdrawal from market without notice.



www.WolfCRE.com

Bethany Brown
Executive Vice President
267.226.6602
bethany.brown@wolfcre.com

