



56 CHESTNUT STREET | LUMBERTON, NJ



## PROPERTY DESCRIPTION

<b>Location</b>	56 Chestnut Street Lumberton, NJ 08048
<b>Size / SF Available</b>	Elementary School: 53,406 SF EDC Building: 2,400 sf
<b>Lease Price</b>	Elementary School: \$10.00/SF (NNN) EDC Building: \$17.00/SF (NNN) Property is situated on +/- 24 acres
<b>Sale Price</b>	Call for more information
<b>Occupancy</b>	Available for immediate occupancy
<b>Property / Area Description</b>	<ul style="list-style-type: none"> <li>• 2 buildings utilized by Lumberton School District</li> <li>• Property is fit-out with classrooms, gymnasium, administrative offices and restrooms</li> <li>• Abundant parking</li> <li>• Ideal property for a daycare, private school, non-profits, professional offices or redevelopment</li> <li>• Easy access to Route I-295 and Route 38</li> </ul>

## Contact Us

Christopher Henderson  
Principal & Vice President  
856.857.6337  
chris.henderson@wolfcre.com

Phil Costa  
Associate  
215.799.6195  
phil.costa@wolfcre.com

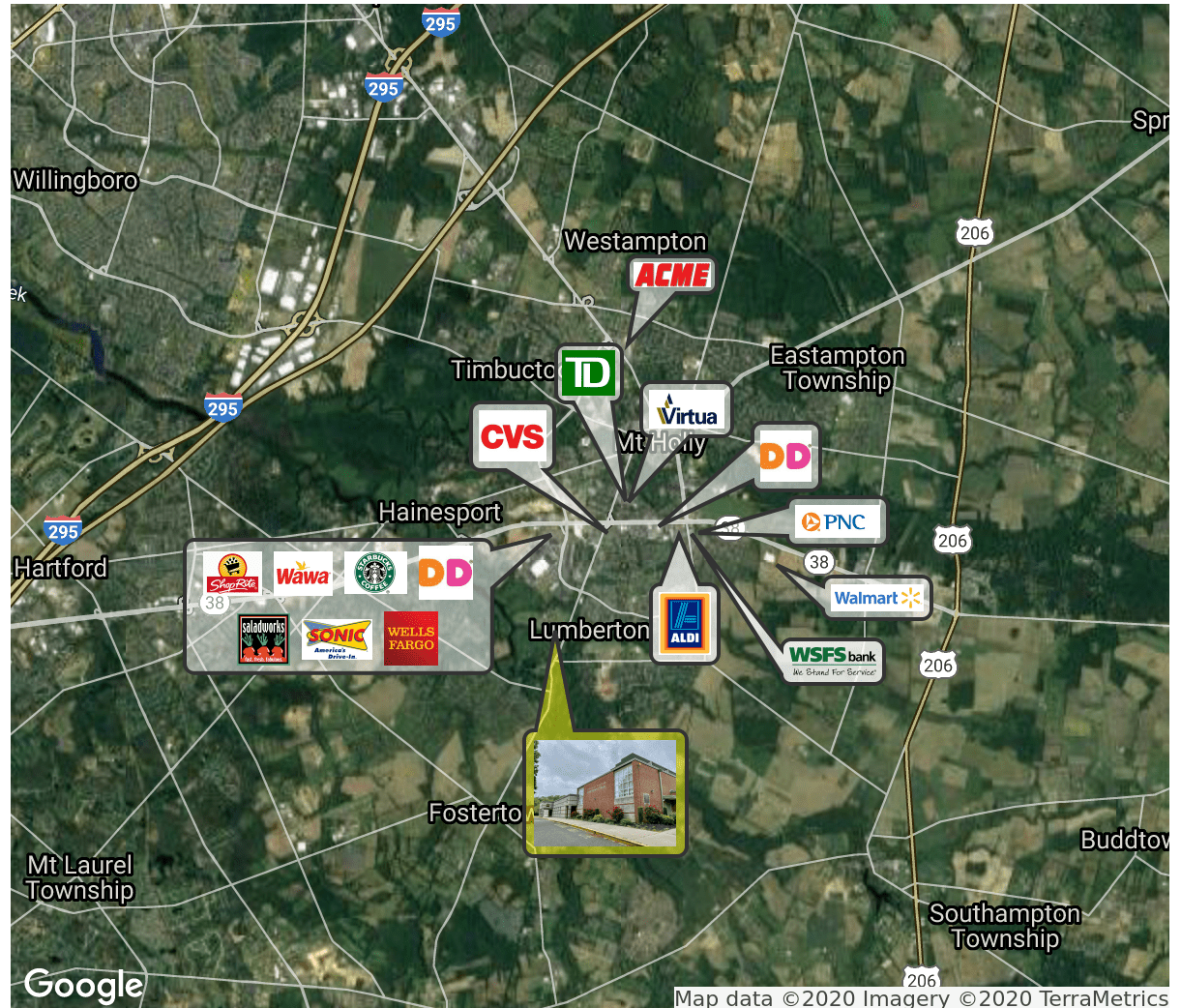

Map data ©2020 Imagery ©2020 TerraMetrics

follow us:    

The foregoing information was furnished to us by sources which we deem to be reliable, but no warranty or representation is made as to the accuracy thereof. Subject to correction of errors, omissions, change of price, prior sale or withdrawal from market without notice.

FLOOR PLANS

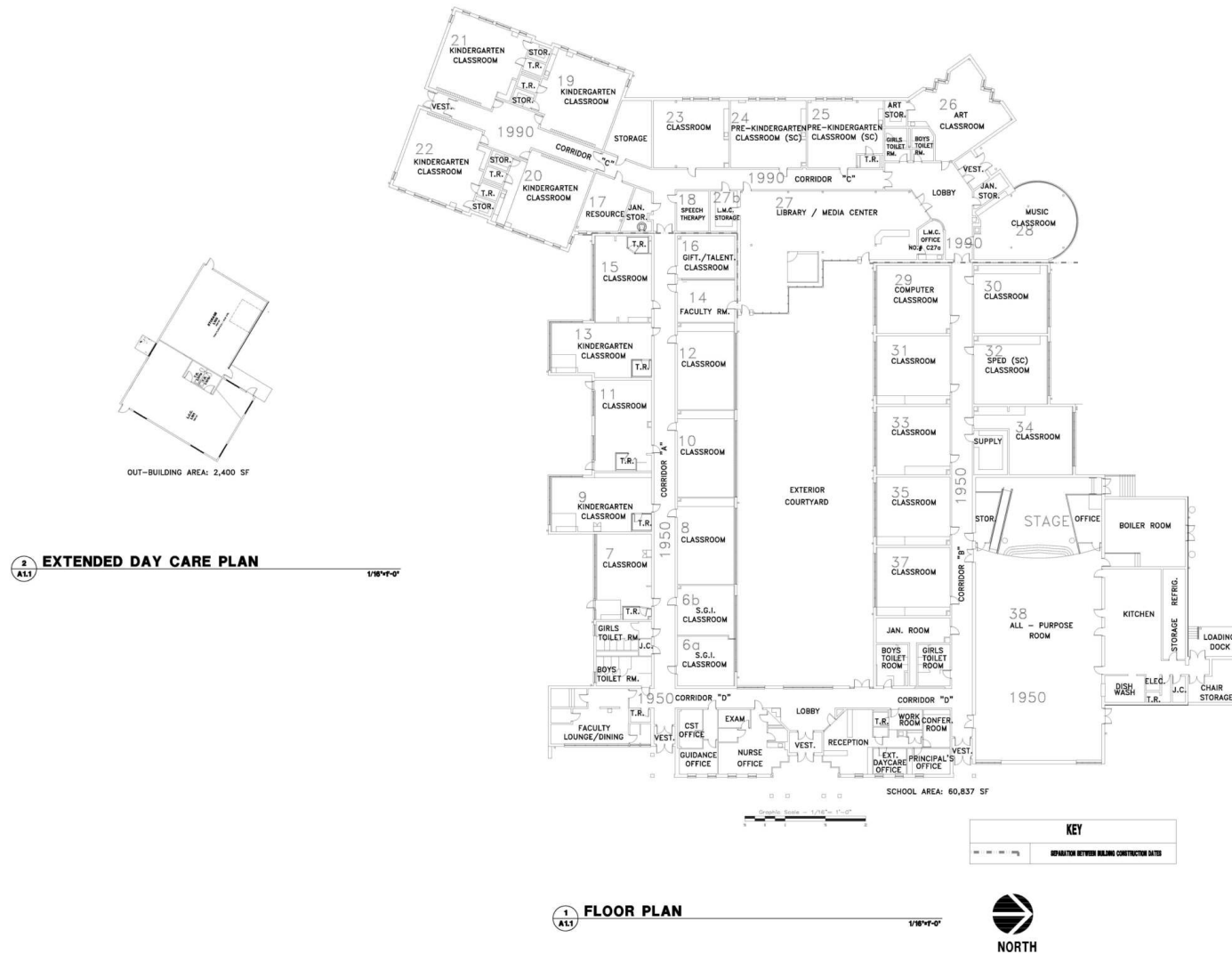

The foregoing information was furnished to us by sources which we deem to be reliable, but no warranty or representation is made as to the accuracy thereof. Subject to correction of errors, omissions, change of price, prior sale or withdrawal from market without notice.

## DEMOGRAPHICS MAP & REPORT

POPULATION	1 MILE	3 MILES	5 MILES
Total Population	4,489	32,561	80,730
Average age	38.0	37.1	38.0
Average age (Male)	37.0	36.0	37.1
Average age (Female)	40.1	38.5	39.3

HOUSEHOLDS & INCOME	1 MILE	3 MILES	5 MILES
Total households	1,527	11,630	30,827
# of persons per HH	2.9	2.8	2.6
Average HH income	\$101,038	\$87,389	\$92,445
Average house value	\$311,415	\$296,533	\$307,944

\* Demographic data derived from 2010 US Census

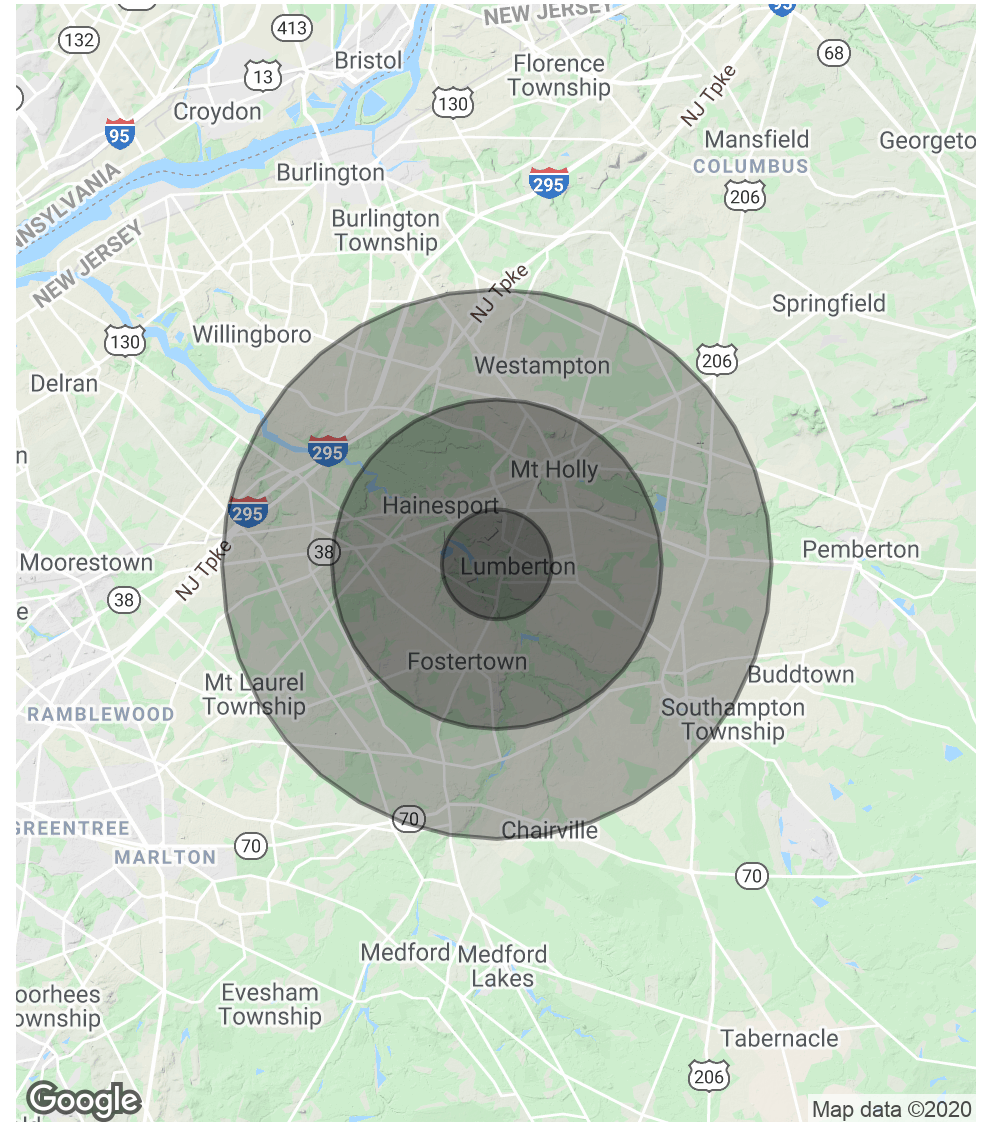

The foregoing information was furnished to us by sources which we deem to be reliable, but no warranty or representation is made as to the accuracy thereof. Subject to correction of errors, omissions, change of price, prior sale or withdrawal from market without notice.