



## PREMIER CHERRY HILL 25,250 SF FLEX BUILDING INVESTMENT OPPORTUNITY



2096 SPRINGDALE ROAD | CHERRY HILL, NJ



Wolf Commercial Real Estate  
**[www.WolfCRE.com](http://www.WolfCRE.com)**



## PROPERTY DESCRIPTION

- |                                    |  |
|------------------------------------|--|
| <b>Location</b>                    | 2096 Springdale Road<br>Cherry Hill, NJ 08003  |
| <b>Size / SF Available</b>         | 25,250 SF  |
| <b>Sale Price</b>                  | \$3,160,000  |
| <b>Signage</b>                     | Building and pylon signage available   |
| <b>Property / Area Description</b> | <ul style="list-style-type: none"> <li>• Sale/Leaseback Investment Opportunity</li> <li>• Ownership will sell as a full building leaseback or will relocate for a full building user</li> <li>• Located at a signaled intersection on Springdale Road and North Olney Avenue</li> <li>• Convenient location with easy access to Route 70, 73, I-295 and the New Jersey Turnpike</li> <li>• Situated within minutes the Cherry Hill Business District</li> <li>• Great visibility from Springdale Road</li> <li>• 4.15/1000 SF Parking Ratio</li> <li>• Situated on 2.09 Acres</li> <li>• Well maintained and landscaped property located in a densely populated area</li> <li>• Convenient access to area shopping, hotels, and restaurants</li> <li>• Within close proximity to all local health systems</li> <li>• Located in a high demographic area of Cherry Hill Township</li> </ul> |

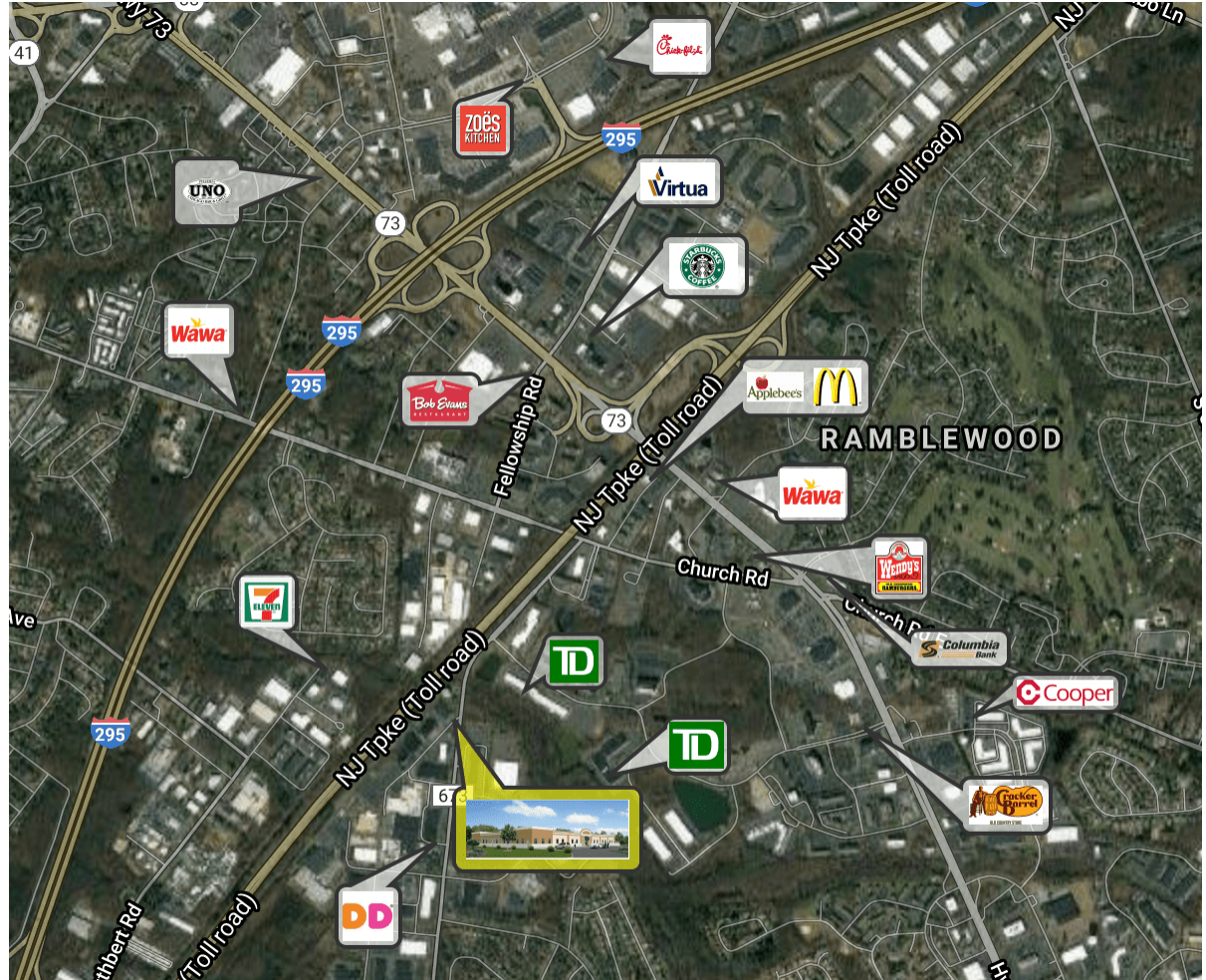

## Contact Us

|  |  |
|--|--|
| Christopher Henderson<br>Principal & Vice President<br>856.857.6337<br>chris.henderson@wolfcre.com | Jason Wolf<br>Managing Principal<br>856.857.6301<br>jason.wolf@wolfcre.com |
|--|--|

follow us:    

The foregoing information was furnished to us by sources which we deem to be reliable, but no warranty or representation is made as to the accuracy thereof. Subject to correction of errors, omissions, change of price, prior sale or withdrawal from market without notice.

## FLOOR PLANS

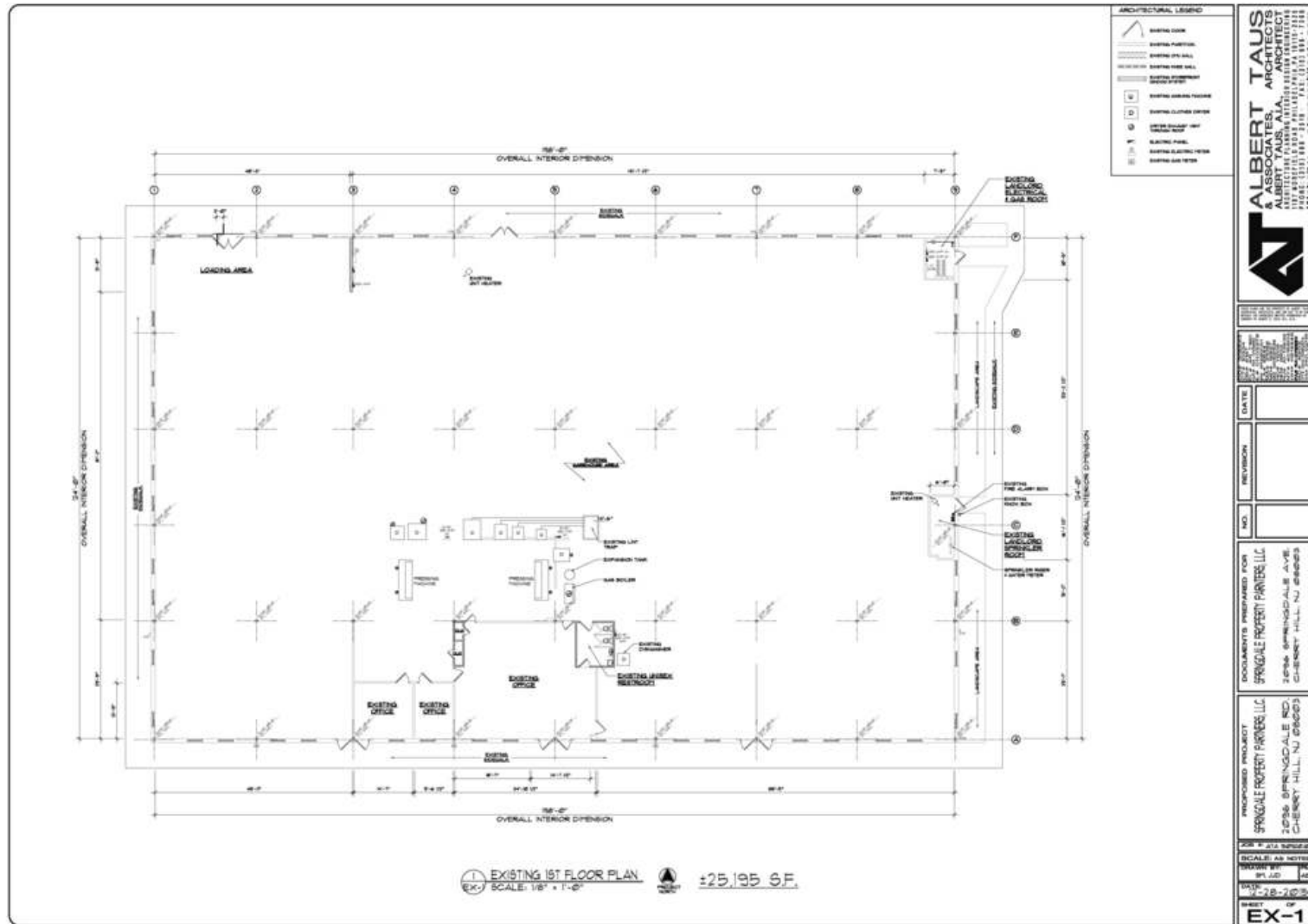

The foregoing information was furnished to us by sources which we deem to be reliable, but no warranty or representation is made as to the accuracy thereof. Subject to correction of errors, omissions, change of price, prior sale or withdrawal from market without notice.





## DEMOGRAPHICS MAP & REPORT

| POPULATION           | 1 MILE | 3 MILES | 5 MILES |
|----------------------|--------|---------|---------|
| Total Population     | 5,605  | 82,419  | 212,742 |
| Average age          | 43.8   | 41.6    | 42.3    |
| Average age (Male)   | 41.0   | 40.1    | 40.7    |
| Average age (Female) | 47.8   | 43.5    | 43.9    |

| HOUSEHOLDS & INCOME | 1 MILE    | 3 MILES   | 5 MILES   |
|---------------------|-----------|-----------|-----------|
| Total households    | 1,810     | 32,205    | 81,221    |
| # of persons per HH | 3.1       | 2.6       | 2.6       |
| Average HH income   | \$117,670 | \$97,022  | \$103,401 |
| Average house value | \$346,374 | \$336,733 | \$323,375 |

\* Demographic data derived from 2010 US Census

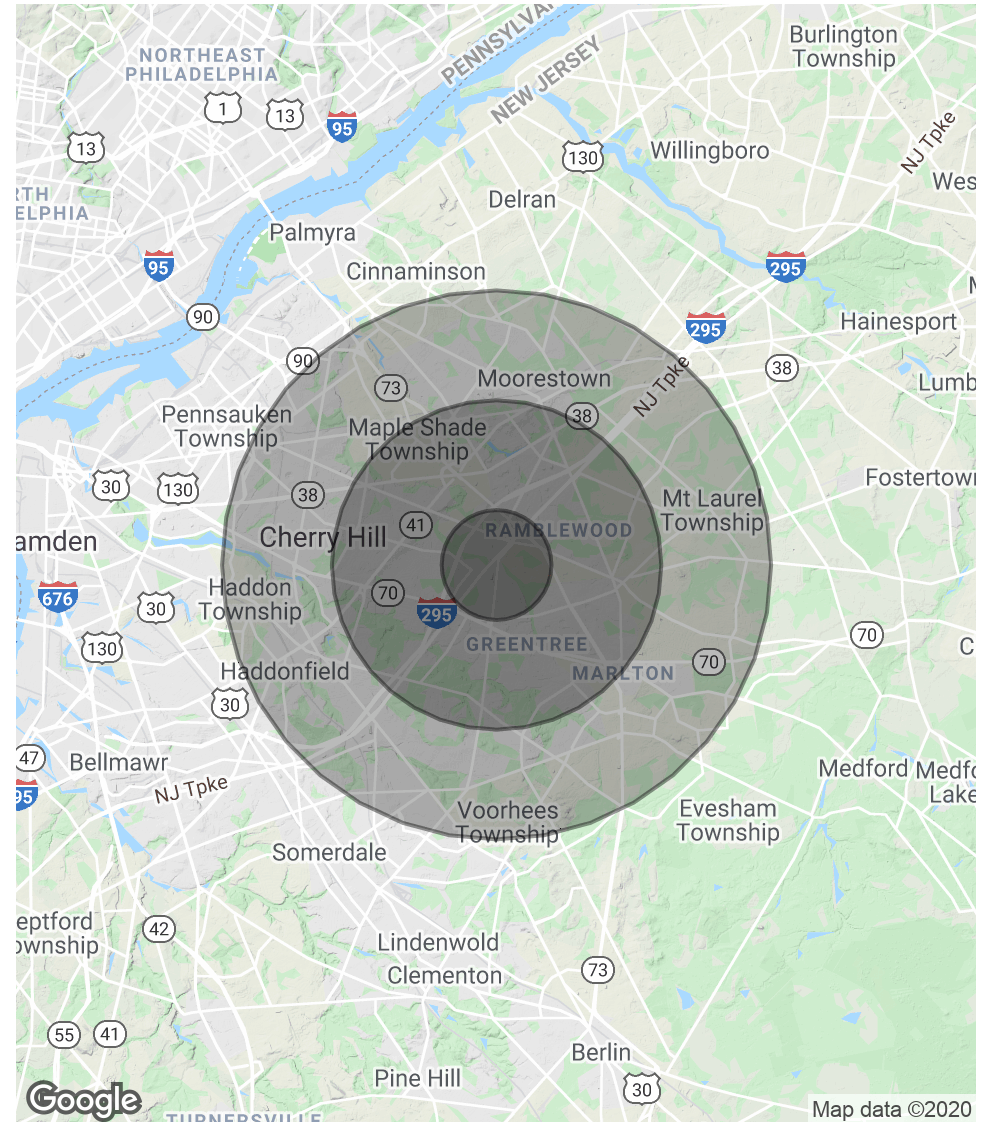

The foregoing information was furnished to us by sources which we deem to be reliable, but no warranty or representation is made as to the accuracy thereof. Subject to correction of errors, omissions, change of price, prior sale or withdrawal from market without notice.