



## PREMIER CLASS "A" PRINCETON SUBLEASE OPPORTUNITY



21 ROSZEL ROAD | PRINCETON, NJ



Wolf Commercial Real Estate  
**[www.WolfCRE.com](http://www.WolfCRE.com)**





## PROPERTY DESCRIPTION

**Location** 21 Roszel Road  
Princeton, NJ 08540

**Size / SF Available** 2,000 - 3,500 SF

**Lease Price** \$35.00/SF (Gross + Electric)

### Property / Area Description

- Located at the gateway to Carnegie Center
- Within minutes of the Princeton Junction Train Station, Princeton MarketFair & Quakerbridge Mall
- Surrounded by a mix of corporate and local tenants
- Situated within the heart of the Princeton business community
- Fully Furnished leasing opportunity
- Coworking leasing options available
- On-site amenities including a fitness center and grab-and-go café
- Princeton University, The Institute for Advanced Study, Rider University, and The College of New Jersey are all within very short drive times
- Close proximity to Route 1, I-295, and I-95 leading to NJ Turnpike
- Across from Princeton US post office

### Contact Us

Kevin Coleman  
Chief Sales Officer & Executive Vice President  
856.857.6339  
kevin.coleman@wolfcre.com



follow us:    

The foregoing information was furnished to us by sources which we deem to be reliable, but no warranty or representation is made as to the accuracy thereof. Subject to correction of errors, omissions, change of price, prior sale or withdrawal from market without notice.

## FLOOR PLANS

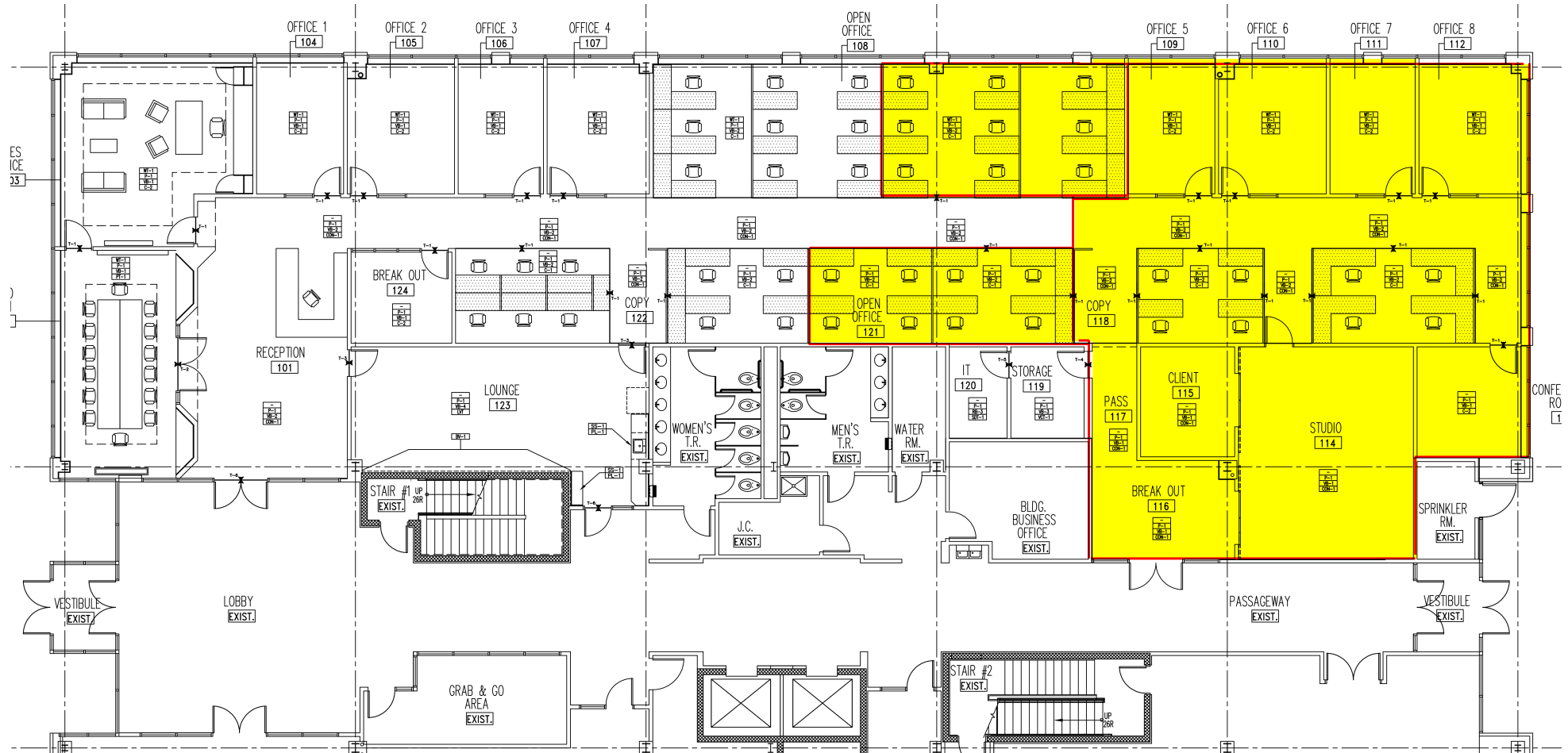

The foregoing information was furnished to us by sources which we deem to be reliable, but no warranty or representation is made as to the accuracy thereof. Subject to correction of errors, omissions, change of price, prior sale or withdrawal from market without notice.



## ADDITIONAL PHOTOS



The foregoing information was furnished to us by sources which we deem to be reliable, but no warranty or representation is made as to the accuracy thereof. Subject to correction of errors, omissions, change of price, prior sale or withdrawal from market without notice.



ADDITIONAL PHOTOS



The foregoing information was furnished to us by sources which we deem to be reliable, but no warranty or representation is made as to the accuracy thereof. Subject to correction of errors, omissions, change of price, prior sale or withdrawal from market without notice.

## DEMOGRAPHICS MAP & REPORT

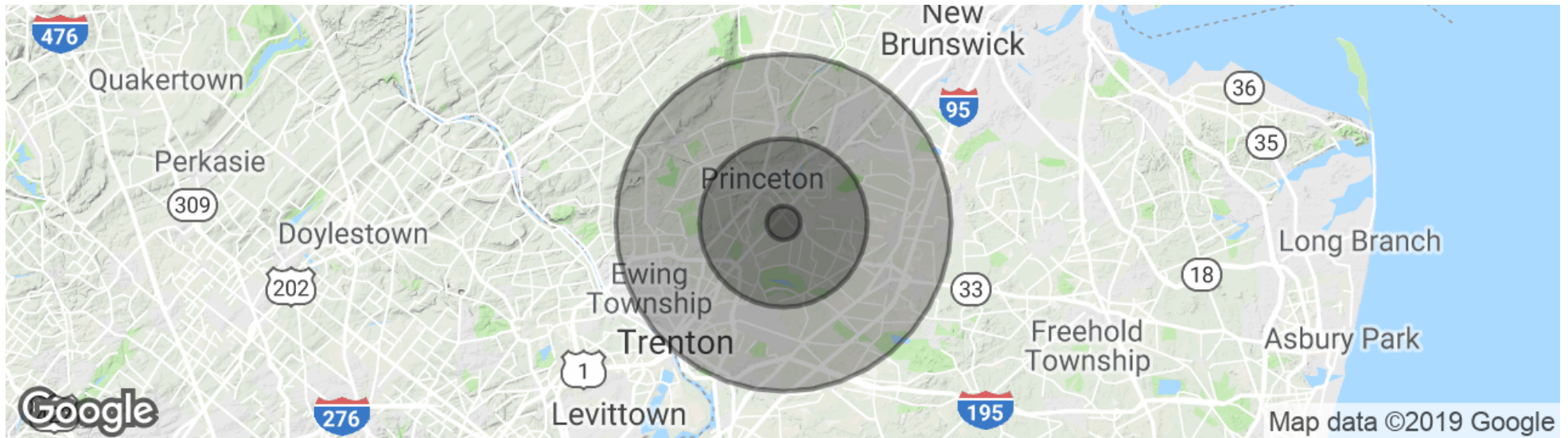

### POPULATION

	1 MILE	5 MILES	10 MILES
Total population	2,964	100,853	428,315
Median age	32.4	37.7	38.4
Median age (Male)	32.4	37.5	37.4
Median age (Female)	32.3	37.8	39.2

### HOUSEHOLDS & INCOME

	1 MILE	5 MILES	10 MILES
Total households	1,127	36,080	154,057
# of persons per HH	2.6	2.8	2.8
Average HH income	\$125,706	\$150,746	\$115,681
Average house value	\$479,001	\$567,335	\$413,791

\* Demographic data derived from 2010 US Census

The foregoing information was furnished to us by sources which we deem to be reliable, but no warranty or representation is made as to the accuracy thereof. Subject to correction of errors, omissions, change of price, prior sale or withdrawal from market without notice.