



NEWLY CONSTRUCTED - CLASS "A" MEDICAL & PROFESSIONAL OFFICE SPACE FOR LEASE



134-136 ROUTE 73 | VOORHEES, NJ



Wolf Commercial Real Estate
www.WolfCRE.com





134-136 ROUTE 73 | VOORHEES, NJ

PROPERTY DETAILS & HIGHLIGHTS

Property Address:	134-136 Route 73, Voorhees, NJ 08043
Size/ SF Available:	2,000 - 25,000 SF
Lease Price:	Competitive rates - call for details
Occupancy:	Available for immediate occupancy
Signage:	Multiple signage opportunities
Parking:	5/1,000 SF

PROPERTY/LOCATION OVERVIEW

- Newly constructed "Class A" Medical/Professional office space
- Located on Route 73 along "Medical Row" Across from Virtua Voorhees Hospital Campus, PowerBack and Genesis Health Care
- Ideal for medical or professional uses
- Signage opportunities
- 5/1,000 SF Parking Ratio
- Dynamic modern design - Interior Fit Out Allowance includes up to \$40.00/SF
- Great visibility with +/-50,000 cars/day along Route 73
- Easy access to I-295, The New Jersey Turnpike and convenient access to The Atlantic City Expressway

Contact Us

John Mozzillo
Senior Associate - Director of Investment Sales
856.857.6304
john.mozzillo@wolfcre.com

Jason Wolf
Managing Principal
856.857.6301
jason.wolf@wolfcre.com



The foregoing information was furnished to us by sources which we deem to be reliable, but no warranty or representation is made as to the accuracy thereof, subject to correction of errors, omissions, change of price, prior sale or withdrawal from market without notice.



Wolf Commercial Real Estate
www.WolfCRE.com

MARLTON, NJ | PHILADELPHIA | KING OF PRUSSIA, PA

FLOOR PLANS

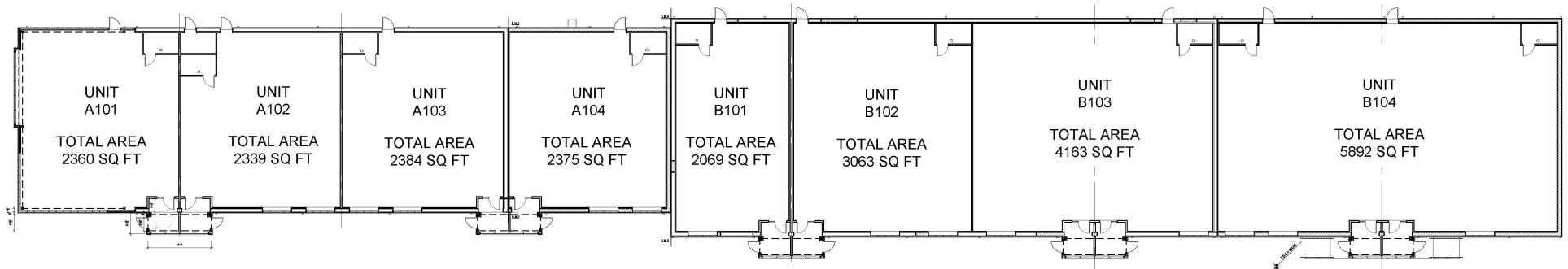

FIRST FLOOR LEASE PLAN 'BUILDING AB'

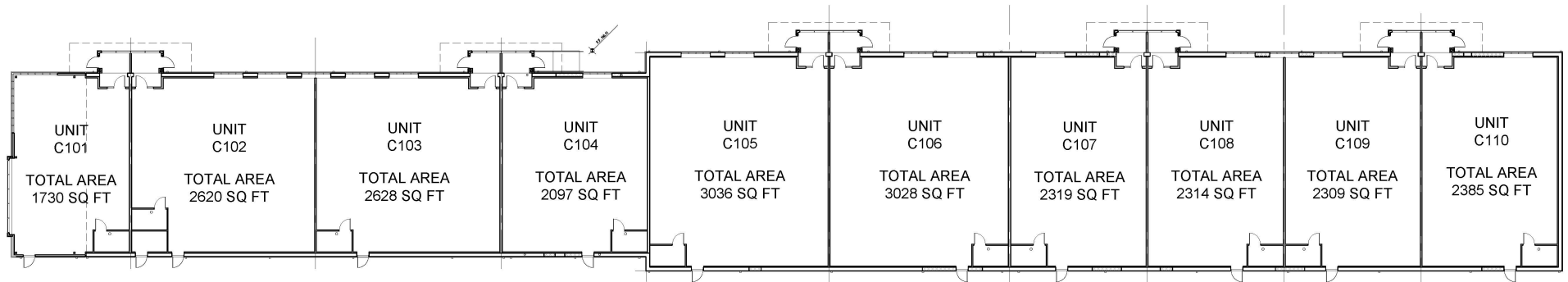

FIRST FLOOR LEASE PLAN 'BUILDING C'



The foregoing information was furnished to us by sources which we deem to be reliable, but no warranty or representation is made as to the accuracy thereof. Subject to correction of errors, omissions, change of price, prior sale or withdrawal from market without notice.

RETAILER MAP



Map data ©2018 Google Imagery ©2018 , DigitalGlobe, Landsat / Copernicus, U.S. Geological Survey, USDA Farm Service .

The foregoing information was furnished to us by sources which we deem to be reliable, but no warranty or representation is made as to the accuracy thereof. Subject to correction of errors, omissions, change of price, prior sale or withdrawal from market without notice.

DEMOGRAPHICS MAP

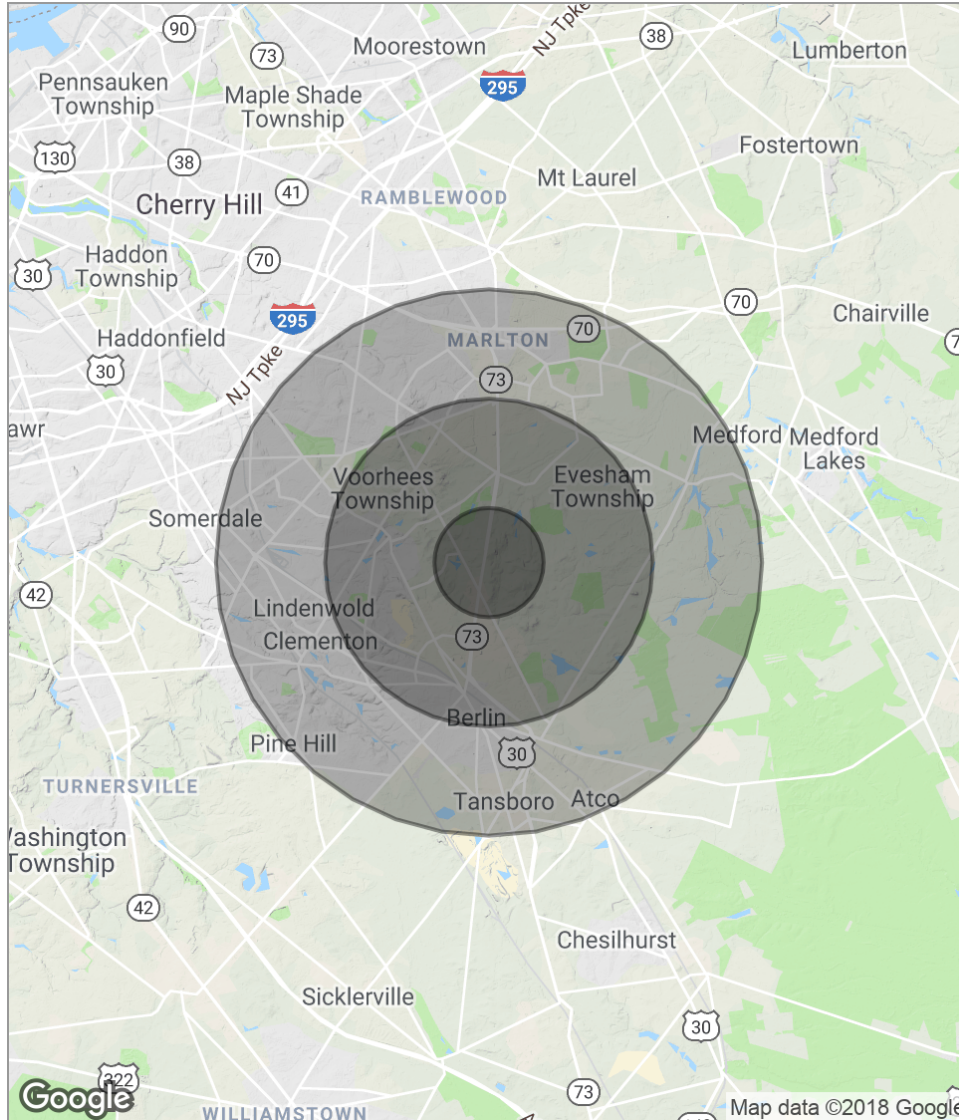

POPULATION	1 MILE	3 MILES	5 MILES
Total population	5,423	45,338	132,442
Median age	40.7	40.3	39.9
Median age (Male)	41.9	39.1	38.1
Median age (Female)	39.1	41.2	41.5
HOUSEHOLDS & INCOME	1 MILE	3 MILES	5 MILES
Total households	1,798	15,950	48,815
# of persons per HH	3.0	2.8	2.7
Average HH income	\$140,257	\$105,360	\$98,809
Average house value	\$484,260	\$442,007	\$349,394

** Demographic data derived from 2010 US Census*

The foregoing information was furnished to us by sources which we deem to be reliable, but no warranty or representation is made as to the accuracy thereof. Subject to correction of errors, omissions, change of price, prior sale or withdrawal from market without notice.