

245 Fries Mill Road Turnersville, NJ

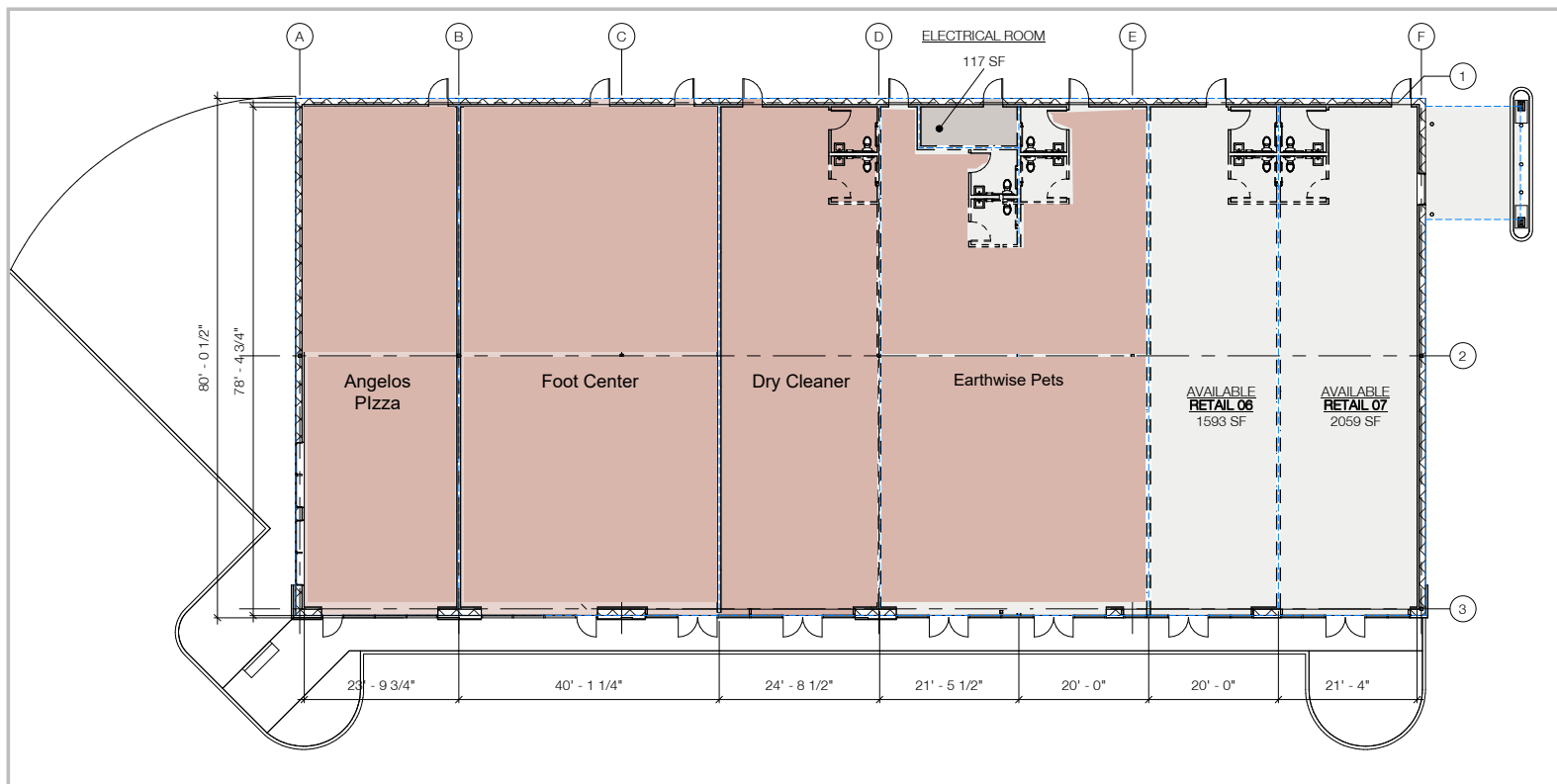

Available | First Floor | +/- 1,593 - 3,652 sf



Wolf Commercial Real Estate, LLC excludes unequivocally all inferred or implied terms, conditions and warranties arising out of this document and excludes all liability for loss and damages arising there from. This publication is the copyrighted property of Wolf Commercial Real Estate, LLC and /or its licensor(s). © 2015. All rights reserved.