



+/- 2,059 SF END-CAP RETAIL SPACE FOR LEASE

Only 1 Store Left!  
Drive Thru  
Available

# RETAIL SPACE FOR LEASE 245 FRIES MILL ROAD | TURNERSVILLE | NJ



## Contact Us

Leor R. Hemo  
Executive Vice President  
D 856 857 6302  
[leor.hemo@wolfcre.com](mailto:leor.hemo@wolfcre.com)

Jason M. Wolf  
Managing Principal  
D 856 857 6301  
[jason.wolf@wolfcre.com](mailto:jason.wolf@wolfcre.com)

Building Features	
Location	Fries Mill Shopping Center 245 Fries Mill Road Turnersville, NJ
Size/SF Available	+/- 2,059 sf End-cap with drive thru
Asking Lease Price	\$20.00/sf NNN
Parking	Abundant parking
Occupancy	Available for immediate occupancy
Signage	Monument and above store signage available
Area/ Property Description	<ul style="list-style-type: none"> <li>▶ Join Earthwise Pet Supply, Angelo's Pizza, Convenience Plus Dry Cleaner, Diabetic Foot Center, Miracle Ear and others</li> <li>▶ End-cap suite has drive thru option</li> <li>▶ High profile, hard corner, signalized intersection</li> <li>▶ Access from Hurffville Crosskeys Rd, and Fries Mill Road</li> <li>▶ Nearby retail includes Target, WalMart, Shop Rite &amp; Acme</li> <li>▶ Near Kennedy Hospital, Virtua Hospital, and Washington Twp. High School</li> <li>▶ Surrounded by high income residential, medical and professional offices.</li> </ul>

follow us:

Wolf Commercial Real Estate  
[www.wolfcre.com](http://www.wolfcre.com)

NJ OFFICE  
951 Route 73 North | Suite D  
Marlton, NJ 08053  
P 856 857-6300 | F 856 283-3950

PA OFFICE  
630 Freedom Business Center | 3rd Floor  
King of Prussia, PA 19406  
P 215 799 6900 | F 610 768 7701

# Building Successful Relationships

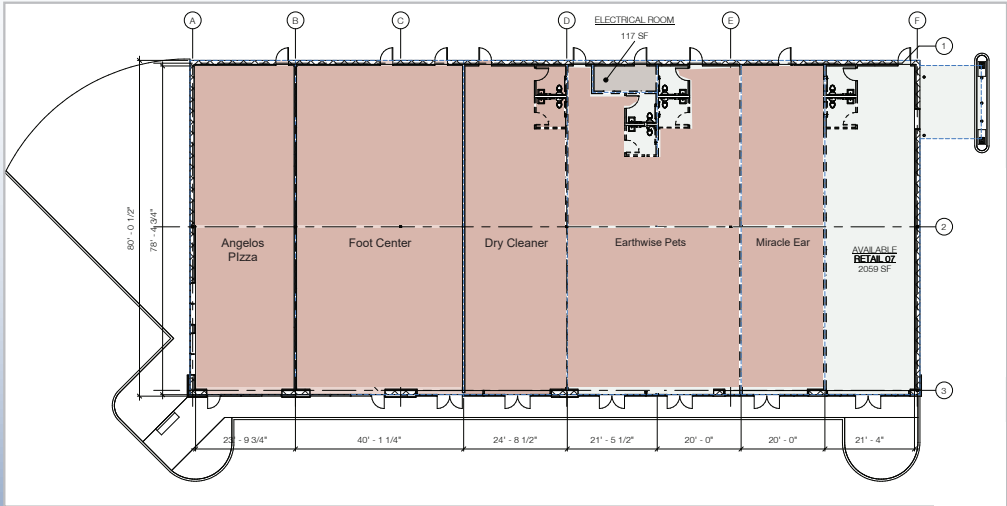

## CONTACT US

Leor R. Hemo, Executive Vice President  
 D 856 857 6302  
[leor.hemo@wolfcre.com](mailto:leor.hemo@wolfcre.com)

Jason M. Wolf, Managing Principal  
 D 856 857 6301  
[jason.wolf@wolfcre.com](mailto:jason.wolf@wolfcre.com)

follow us:

## DEMOGRAPHIC SUMMARY

	1 Mile	3 Miles	5 Miles
Population	7,221	55,192	152,347
Households	2,589	19,124	53,685
Median HH Income	\$83,365	\$82,713	\$74,232
Avg HH Income	\$94,992	\$96,583	\$88,729



The foregoing information was furnished to us by sources which we deem to be reliable, but no warranty or representation is made as to the accuracy thereof. Subject to correction of errors, omissions, change of price, prior sale or withdrawal from market without notice.