

## CLASS A OFFICE SPACE 1005 ASTORIA BOULEVARD | CHERRY HILL | NJ



### Contact Us

Leor R. Hemo  
 Executive Vice President  
 D 856 857 6302  
[leor.hemo@wolfcre.com](mailto:leor.hemo@wolfcre.com)

Jason M. Wolf  
 Principal  
 D 856 857 6301  
[jason.wolf@wolfcre.com](mailto:jason.wolf@wolfcre.com)

#### Building Features

Location	1005 Astoria Boulevard Cherry Hill, NJ
Size/SF Available	Up to +/-18,000 sf available for occupancy on January 2015
Asking Lease Price	\$23.00/sf NNN
Parking	4/1,000 sf
Occupancy	Available for occupancy on January 2015
Signage	Monument and building signage available
Property Description	Class A, high performance office building consists of about 18,000 sf of rentable space. Available for occupancy on January 2015.
Area Description	Conveniently located off the intersection of Route 70 and Astoria Boulevard providing for immediate access to I-295, NJ Turnpike, Routes 38 and 73. Within minutes drive to Philadelphia, Burlington and Gloucester counties. Great access to many local amenities.

follow us:   

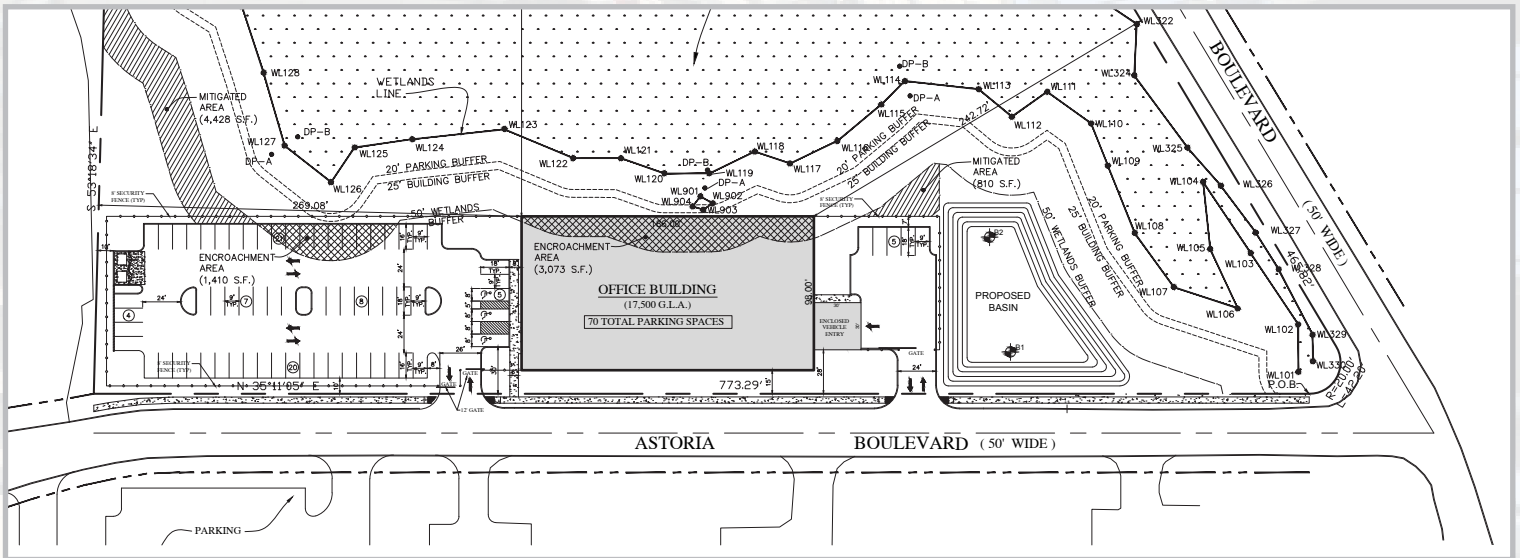

## DEMOGRAPHIC SUMMARY

	1 Mile	3 Miles	5 Miles
Population	7,428	84,869	236,610
Household	3,011	33,534	93,638
Median HH Income	\$93,384	\$84,612	\$78,594
Avg HH Income	\$115,856	\$106,480	\$100,536

## CONTACT Us

Leor R. Hemo  
 Executive Vice President  
 D 856 857 6302  
[leor.hemo@wolfcre.com](mailto:leor.hemo@wolfcre.com)

Jason M. Wolf  
 Principal  
 D 856 857 6301  
[jason.wolf@wolfcre.com](mailto:jason.wolf@wolfcre.com)

follow us:   



The foregoing information was furnished to us by sources which we deem to be reliable, but no warranty or representation is made as to the accuracy thereof. Subject to correction of errors, omissions, change of price, prior sale or withdrawal from market without notice.